

# D'MAND CIRC® SPECIFICATIONS

## TECHNICAL & ELECTRICAL DATA

Flow range:	0-34 gpm
Head range:	0-32 feet
Motors:	2-pole, single-phase
Max. liquid temperature:	230°F (110°C)
Min. liquid temperature:	36°F (2°C)
Max. system pressure:	145 psi (10 bar)

Model	Volts	Amps	Watts	Hp	Capacitor
UP 26-99 F/BF	115	2.15	245	1/6	10µF/180 V
	230	1.07	245	1/6	2.5µF/380 V

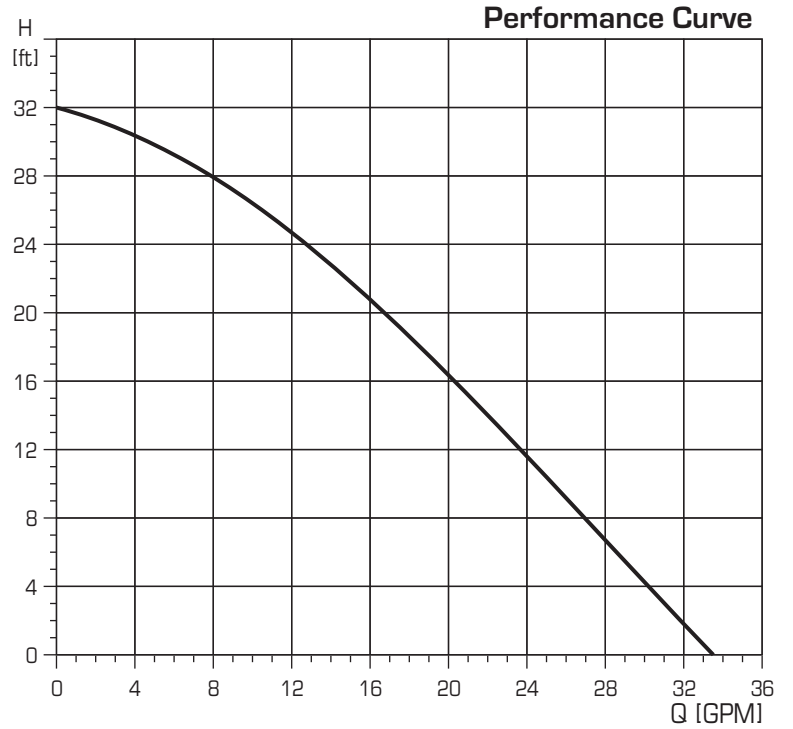

## SIZE & WEIGHT

Model	Type and Size	Wt. (lbs)
UP 26-99 F/BF	Flange - (2) 1/2" Dia. Bolt Holes	12 1/2

UP26-99

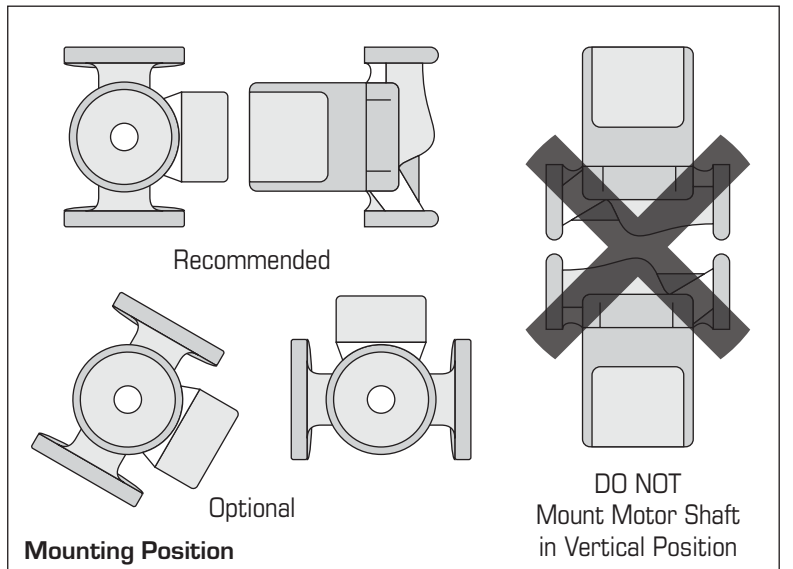

## MATERIALS OF CONSTRUCTION

DESCRIPTION	MATERIAL	DESCRIPTION	MATERIAL
Inlet Cone, Bearing Plate, Bearing Retainers, Rotor Can, Rotor Cladding Shaft Retainer	304 Stainless Steel	Pump Housing (Volute)	Silicon bronze C875 or Stainless steel 300 series
Stator Housing	Aluminum	O'Ring & Gaskets	EP (Ethylene Propylene Rubber)
Shaft, Upper & Lower Radial Bearings	Aluminum Oxide Ceramic	Impeller	PES Composite (30% Glass Filled)
Thrust Bearing	Carbon bearing and EPDM retainer	Terminal Box	Noryl®
Check Valve	ACETAL with 302 Stainless Steel Spring & Nitrile Rubber Seats		

**NOTE:** Noryl® is a registered trademark of General Electric Company. BRUTE II® is a registered trademark of Grundfos Pumps Corporation

# D'MAND® CIRC ACCESSORIES

## D'MAND® FLOW SENSOR

Positive stop essentially eliminates fatigue effect of turbulence, vibration, and flow surge on flow detecting element
Very low pressure drop-typically less than 1.0 psi at normal flow rate
Line pressure to 250 psig
Temperature to 200°F continuous
<b>Flow Range Water Calibrated @ 70°F</b>
<b>Nominal Working Temperature/Pressure</b>
200°F @ ambient pressure
250 PSI @ PSI room temperature

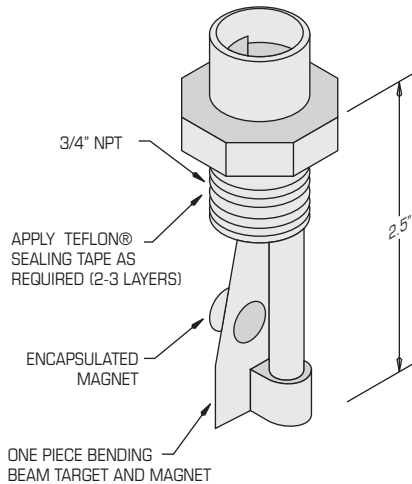

## TEMPERATURE SENSOR

RESISTANCE @ +25°C = 10,000 Ω +/- 1%
RESISTANCE/TEMPERATURE CURVE = "J"
TEMPERATURE COEFFICIENT @+25°C = -4.4%/°C NOMINAL
BETA "β" (0 TO +55°C) = 3,892°K NOMINAL
MAXIMUM TEMPERATURE RATING = +105°C
LEAD WIRE: 24 AWG, STRANDED CONDUCTOR, TWO CONDUCTOR, PVC INSULATED ZIPCORD

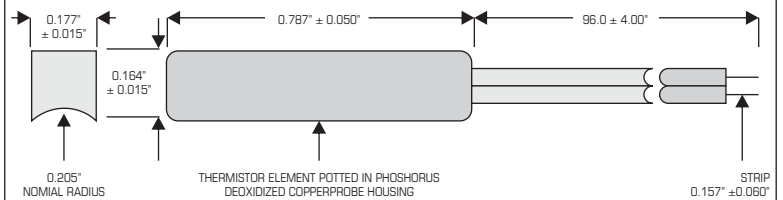

## KONTROL BOX

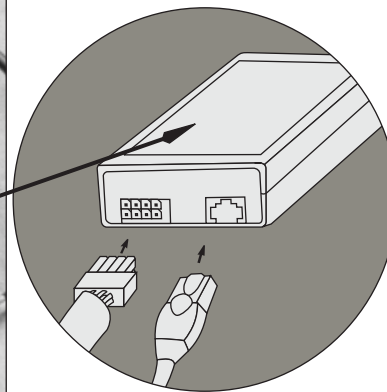

**Switches:**  
controls operate D'MAND and continuous settings

**Potentiometer:**  
temperature control at which pump shuts off

**LED Indicator:**  
diagnostic light for observing demand sensor function

**AutoPrime Jumpers:**  
three controls for adjusting time interval at which system automatically primes circulation

**Control Box:**  
waterproof plastic housing with connection ports

JOB or CUSTOMER:					
ENGINEER:					
CONTRACTOR:					
SUBMITTED BY:		APPROVED BY:		ORDER NO:	
Date:		Date:		Date:	